

R.E. Shaeffer

# Elementary Structures for Architects and Builders

Fifth Edition

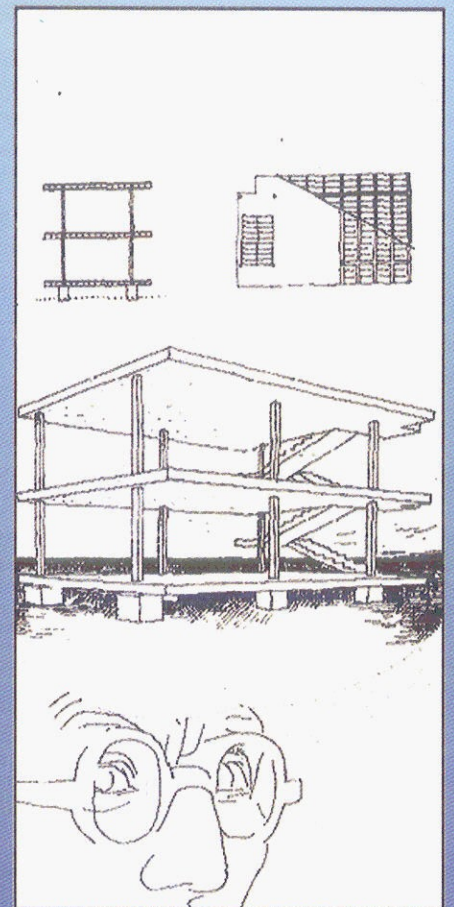

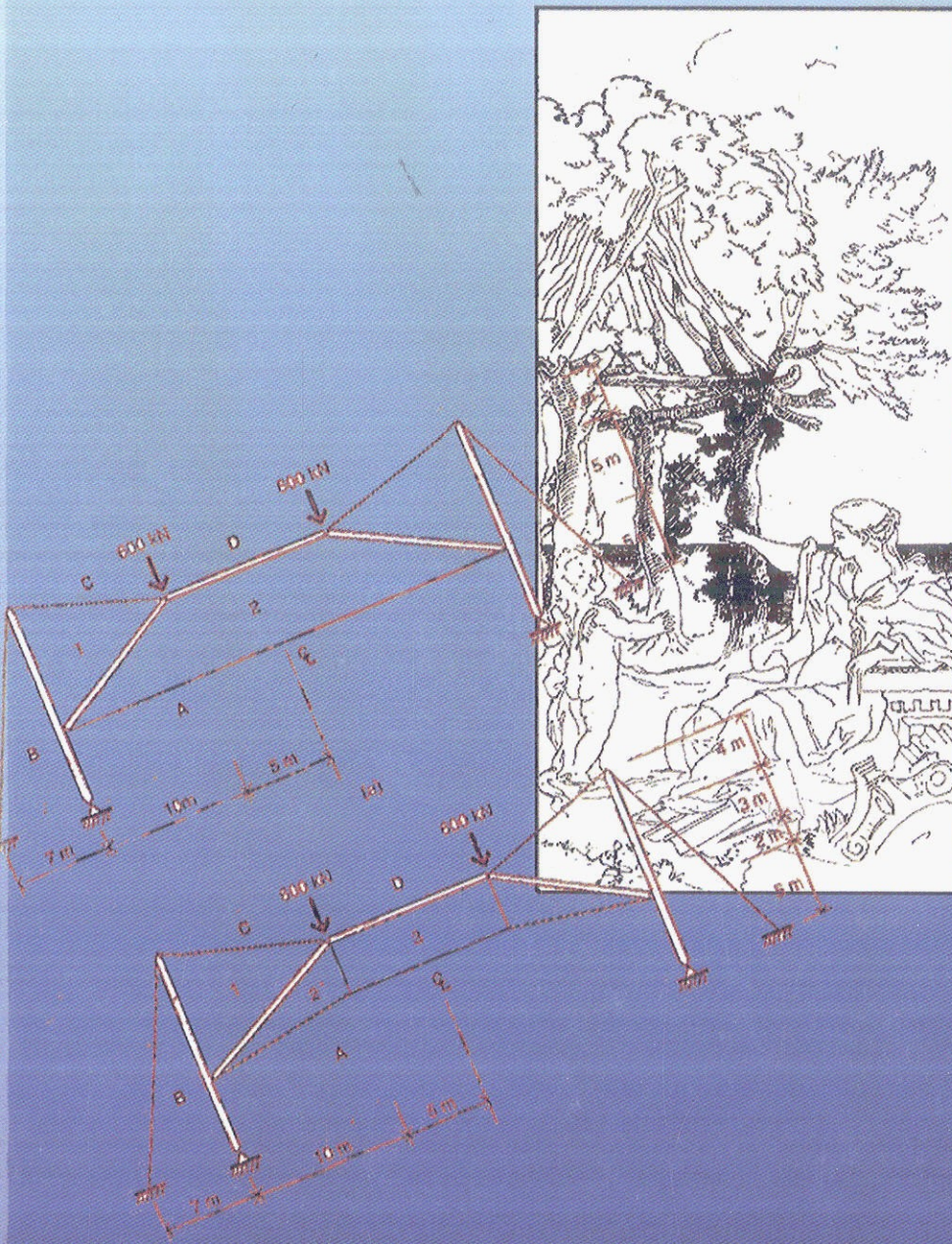

# CONTENTS

---

## 1 | OVERVIEW 1

---

- 1.1 Definition of Structure 1
- 1.2 Building Structure 2
- 1.3 Structural Planning and Design 4
- 1.4 Types of Loads 7
- 1.5 Types of Stress 8
- 1.6 Structural Forms in Nature 9
- 1.7 Structural Elements in Buildings 12
- 1.8 Structure and Architectural Character 19
- 1.9 Cost 20
- 1.10 Building Codes 21
- 1.11 Accuracy of Computations 22

## 2 | STATICS 25

---

- 2.1 Introduction 25
- 2.2 Forces 26
- 2.3 Components and Resultants 26
- 2.4 Equilibrium of Concurrent Forces 27
- 2.5 Moments and Couples 29
- 2.6 Ideal Support Conditions 36
- 2.7 Rigid-Body Concept and Free-Body Diagrams 41
- 2.8 Equilibrium of Cantilevered Members 62
- 2.9 Equilibrium of Simple Beams and Frames 37
- 2.10 Two-Force Members 35
- 2.11 Graphical Techniques 37
- 2.12 Shed and Gable Members 39

2.13	Stability and Determinacy	95
2.14	Pinned Frames	98
2.15	Simple Cable Statics	104
2.16	Maxwell Diagram Analysis of Suspension Structures	120
2.17	Maxwell Diagram Analysis of Other Structures	136
2.18	Conclusion and Procedure	155

### **3 | STRUCTURAL PROPERTIES OF AREAS 157**

---

3.1	Introduction	157
3.2	Centroids	158
3.3	Moment of Inertia	168
3.4	Parallel Axis Theorem	177
3.5	Radius of Gyration	184

### **4 | STRESS AND STRAIN 189**

---

4.1	Types of Stress	189
4.2	Basic Connection Stresses	192
4.3	Strain	193
4.4	Stress Versus Strain	197
4.5	Stiffness	199
4.6	Total Axial Deformation	202
4.7	Thermal Stresses and Strains	205
4.8	Allowable Stress Design and Limit States Design	210

### **5 | PROPERTIES OF STRUCTURAL MATERIALS 213**

---

5.1	Introduction	213
5.2	Nature of Wood	213
5.3	Concrete and Reinforced Concrete	217
5.4	Structural Steel	219
5.5	Masonry and Reinforced Masonry	220
5.6	Creep	221

### **6 | SHEAR AND MOMENT 223**

---

6.1	Definitions and Sign Conventions	223
6.2	Shear and Moment Equations	225
6.3	Significance of Zero Shear	236

6.4 Load, Shear, and Moment Relationships 239

6.5 Uniformly Varying Loads 248

## **7 | FLEXURAL STRESSES 253**

---

7.1 Introduction 253

7.2 Flexural Strain 254

7.3 Flexural Stress 255

7.4 Section Modulus 273

7.5 Lateral Buckling and Stability 283

## **8 | SHEARING STRESSES 287**

---

8.1 Nature of Shearing Stresses 287

8.2 Diagonal Tension and Compression 288

8.3 Basic Horizontal Shearing Stress Equation 289

8.4 Horizontal Shearing Stresses in Timber Beams 293

8.5 Horizontal Shearing Stresses in Steel Beams 302

## **9 | DEFLECTION AND INDETERMINATE BEAMS 307**

---

9.1 Introduction 307

9.2 Moment-Area Method 309

9.3 Principle of Superposition 318

9.4 Use of Deflection Formulas 320

9.5 Superposition and Indeterminate Structures 324

9.6 Theorem of Three Moments 330

9.7 Loading Patterns 339

## **10 | BEAM DESIGN AND FRAMING 341**

---

10.1 Introduction 341

10.2 Shape of Beam Cross Sections 342

10.3 "Ideal" Beams 343

10.4 Properties of Materials 344

10.5 Tributary Area 345

10.6 Framing Direction 348

10.7 Selecting Wood Beams 351

10.8 Selecting Steel Beams 371

10.9 Design Aids for Wood and Steel 399

## 11 | ELASTIC BUCKLING OF COLUMNS 391

---

- 11.1 Columns as Building Structural Elements 391
- 11.2 Column Failure Modes 392
- 11.3 The Euler Theory 395
- 11.4 Influence of Different End Conditions 400
- 11.5 Intermediate Lateral Bracing 411
- 11.6 Limits to the Applicability of the Euler Equation 419
- 11.7 Eccentric Loading and Beam-Columns 420

## 12 | TRUSSES 421

---

- 12.1 Introduction 421
- 12.2 Analysis by Joint Equilibrium 425
- 12.3 Analysis by Maxwell Diagram 435
- 12.4 Method of Sections 446
- 12.5 Special Types of Trusses 453

## APPENDICES 457

- Appendix A Derivation of Basic Flexural Stress Equation 457
- Appendix B Derivation of Basic Horizontal Shearing Stress Equation 461
- Appendix C Derivation of Euler Column Buckling Equation 464
- Appendix D Weights of Selected Building Materials 466
- Appendix E Properties of Selected Materials 467
- Appendix F Properties of Areas 469
- Appendix G Proof of Moment-Area Theorems 471
- Appendix H Allowable Stresses and Modulus of Elasticity Values for Selected Structural Sawn Lumber 475
- Appendix I Wood Section Properties 477
- Appendix J Properties of Selected Steel Sections 479
- Appendix K Shear, Moment, and Deflection Equations 483
- Appendix L Introduction to the SI Metric System 487

## ANSWERS TO PROBLEMS 493

## INDEX 521