

SKETCHBOOK TO ACCOMPANY

Engineering Drawing

A.W. BOUNDY

Mc
Graw
Hill

ISBN 007-125179-0



9 780073 251792

SKETCHBOOK TO ACCOMPANY

Engineering Drawing

A.W. BOUNDY

AssDipMechEng, MPhil

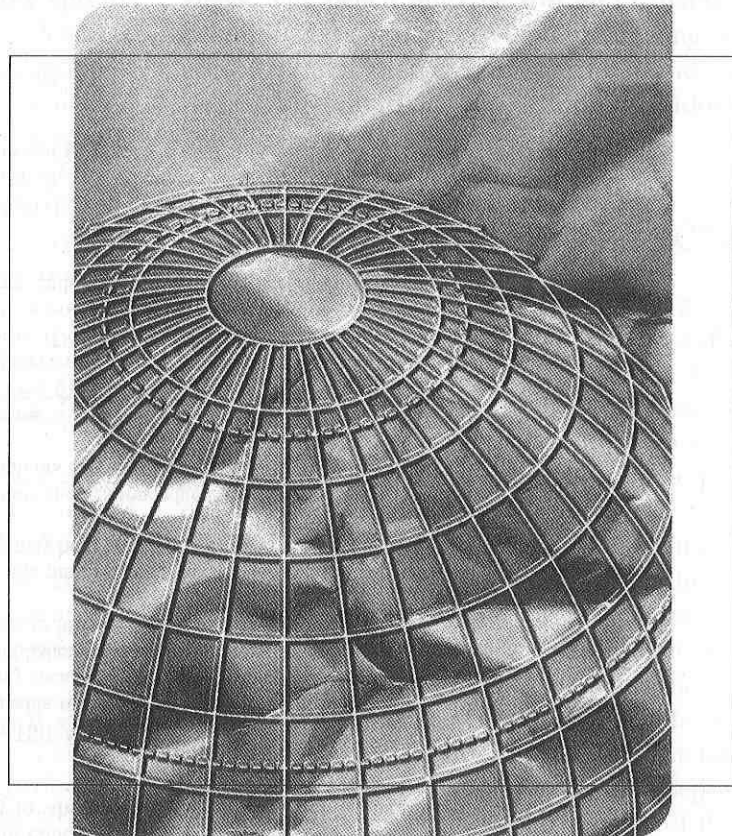

**Mc
Graw
Hill**

Boston Burr Ridge, IL Dubuque, IA Madison, WI New York
San Francisco St. Louis Bangkok Bogotá Caracas Kuala Lumpur
Lisbon London Madrid Mexico City Milan Montreal New Delhi
Santiago Seoul Singapore Sydney Taipei Toronto



Boundy, A.W (Albert William)
Sketchbook to accompany Engineering Drawing 6e
International Edition 2006

Exclusive rights by McGraw-Hill Education (Asia), for manufacture and export. This book cannot be re-exported from the country to which it is sold by McGraw-Hill. The International Edition is not available in North America.

Copyright © 2002 by McGraw-Hill Australia Pty Limited. Additional owners of copyright are named in on-page credits. All rights reserved. No part of this publication may be reproduced or distributed in any form or by any means, or stored in a database or retrieval system, without the prior written consent of the publisher, including, but not limited to, in any network or other electronic storage or transmission, or broadcast for distance learning.

Apart from any fair dealing for the purposes of study, research, criticism or review, as permitted under the *Copyright Act*, no part may be reproduced by any process without written permission.

Every effort has been made to trace and acknowledge copyright material. Should any infringement have occurred accidentally the authors and publishers tender their apologies.

Copying for educational purposes

Under the copying provisions of the *Copyright Act*, copies of parts of this book may be made by an educational institution. An agreement exists between the Copyright Agency Limited (CAL) and the relevant educational authority (Department of Education, University, VET, etc.) to pay a licence fee for such copying. It is not necessary to keep records of copying except where the relevant educational authority has undertaken to do so by agreement with the Copyright Agency Limited.

For further information on the CAL licence agreements with educational institutions, contact the Copyright Agency Limited, Level 19, 157 Liverpool Street, Sydney, NSW 2000. Where no such agreement exists, the copyright owner is entitled to claim payment in respect of any copies made.

10 09 08 07 06 05 04 03 02 01
20 09 08 07 06
CTF ANL

When ordering this title, use ISBN 007-125179-0

Printed in Singapore

The art of freehand sketching is one that all tradespersons, draftspersons, technicians and professional engineers will have to develop to some degree of competence very early in their careers.

Communication in engineering often involves transferring ideas of shape, size, form and dimension to clients and others within the profession. Engineering drawings are normally the final outcome of the design process and form part of the specification and contract documents between the client and engineer. However, in the lead up to the production of engineering drawings, engineers, draftspersons and tradespersons generally produce numerous freehand sketches to assess formative ideas before reaching a final decision. The ability to produce a good freehand sketch is, therefore, a desirable asset when discussing final configurations of designs leading up to the production of detailed drawings.

Types of freehand sketches

Types of sketches can vary from so-called rough 'mud maps' to accurate detailed sketches produced on prepared sketching paper similar to that used in this book. However, the type selected should convey to the recipient of the sketch sufficient information to enable this person to proceed into the next stage of the design process.

The drawer of the sketch must decide if it should be two- or three-dimensional and whether it should be dimensioned or not. The engineering experience of the drawer will determine the choice of what is done.

Two-dimensional sketches are normally multi-view sketches based on the principles of orthogonal projection. This type of sketch is the simplest to draw and can easily include dimensions, but it lacks the 'true to life' look provided by a good three-dimensional sketch. The latter, however, is harder to draw and, unless it is a reasonable attempt, can fail to adequately provide the 'true to life' appearance.

Sketching materials

An ideal medium on which to produce a freehand sketch is prepared sketching paper, either orthogonal or isometric depending on the sketch to be prepared. If available, it should always be used, and a supply

should be provided if it is known that sketches will have to be produced on the site or at a meeting. Sometimes it is necessary to use normal ruled paper, but this makes the task of producing a good sketch much harder.

Other essential sketching materials are an HB (or darker) 0.5 mm clutch pencil and a white eraser. A ruler, while not essential, is helpful when setting out views. The pencil must be soft and capable of producing a dark line easily. It is frustrating trying to read a sketch that is faintly drawn and does not readily distinguish between outlines, hidden detail and dimension lines.

Two-dimensional sketches

Two-dimensional sketches normally comprise one or more orthogonal views of a component and may or may not be accompanied by dimensions. It is just as important when sketching orthogonal views as when drawing them to place them relative to each other according to the principles of third-angle projection explained in textbooks.

Orthogonal views (front, top, right and left side) generally comprise a variety of straight lines, circles and arcs. Centre lines (long dash, short dash), hidden detail lines (short dashes) and dimension lines (light lines) are necessary to complete these views. When using prepared sketching paper the length of straight lines is easily assessed if the dots on the sketching paper are taken as either 5 mm or 7 mm apart, depending on the direction being measured. The scale of distance is shown in the top right-hand corner of each page.

Sketching techniques

Individuals usually will develop their own techniques when sketching straight lines and circles: the finished sketch is the important outcome of the exercise, not how it is done. However, a few hints will help to point beginners in the right direction for developing their own skills.

The easiest line to draw is a left to right line drawn horizontally across the page. Fortunately, all straight lines can be made left to right and horizontal simply by turning the sketching book around until it is in the correct position. If there is adequate time it is a good

idea to *lightly* sketch the whole drawing and then, when you are sure everything is correct, proceed with final lining in using a single heavy stroke of the pencil. The reason for drawing a light outline first is that you will make frequent errors and it only requires a light touch of the rubber to erase light lines.

The hardest line to sketch is the circle or arc and you will have to develop the skill to produce shapes that look reasonably like circles. Following these simple steps will help you to produce a circle that is satisfactory. (It is the method the author finds best for drawing the circle outline, but it may not necessarily suit everyone.)

1. Find the centre of the circle and if it is a small circle ($\text{Ø}20$ mm or less) find four points on the circumference 90 degrees apart (Fig.1(a)).
2. Commence at the left diametral point and *very slowly* draw a light circular arc clockwise to the top diametral point. Then from the right diametral point very slowly draw a light circular arc clockwise to the bottom diametral point. Turn the paper through 90 degrees and repeat the two arcs to complete the circle. If the circle looks true, line it in slowly. If it is out of shape, erase the offending line and try again. Left handers should start at the right diametral point and move anti-clockwise.
3. For circles greater than $\text{Ø}20$ mm select the four diametral points as in point 1, plus four more

diagonal (45 degrees) diametral points (Fig.1(b)). The distance for the diagonal diametral points can be easily assessed as the diagonal distance between points is 7 mm.

4. Proceed as in point 2, ensuring that the circular arcs pass through the diagonal points in a smooth curve.

Sketching isometric and oblique circles

Circles and part circles requiring construction in isometric sketches are all contained within the framework of a rhombus (that is, a square pushed out of shape). However, in oblique sketching the front face is not distorted and circular detail contained within this view remain as circles, while circles contained on the top or either end face are distorted and contained within the framework of a rhomboid (that is, a rectangle pushed out of shape).

The result of the distortion in both types of pictorial sketching is that circles become ellipses and need to be plotted if some degree of accuracy and correct shape is to be achieved. Figure 2(a) on p. vi illustrates circles and part circles found on isometric sketches. There are three types of isometric circles (ellipses) and these are illustrated on the sketch

FIGURE 1

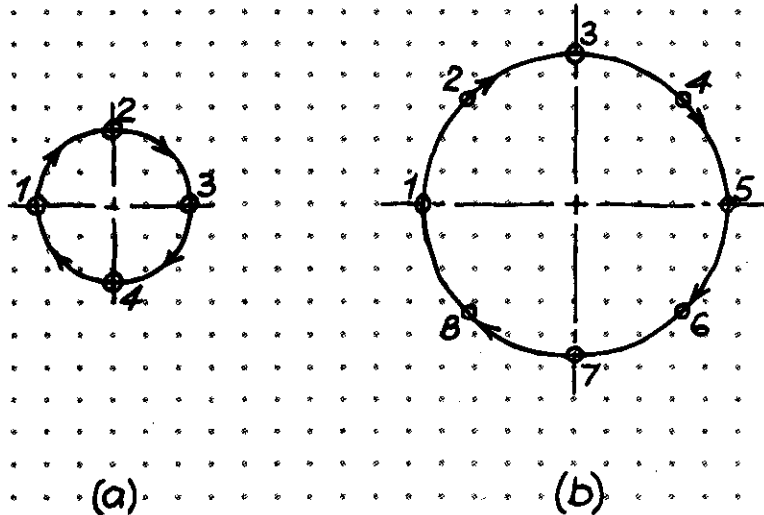

marked 'circle types'. The circles are identical but have different orientations according to which isometric face they lie on. A small circle can easily be outlined within its rhombus by drawing the dividers of each side to intersect at the centre of the rhombus. Where the dividers intersect the side gives four points on the ellipse. For a large circle eight points are required and after drawing in the side dividers to give four points E, F, G and H, the two diagonals AC and BD are drawn and they too intersect at the centre O of the rhombus. Join EH and FG and divide that part of the long diagonal equally, from A and C on to EH and FG, respectively, to give two more points on the ellipse. The other two points are found by dividing BO and DO in the ratio of 1:2.

Corners are plotted using two points found by drawing the particular corner rhombus (Fig.2(a)). A rounded end requires two corner rhombuses and five points as shown.

Oblique circles are much narrower than isometric circles, being plotted in rhomboids having their short side equal to half the length of the long side (Fig.2(b)). Similarly to isometric circles, the small oblique circle is sketched using four points, found by drawing the side dividers. Sketching the oblique ellipse is somewhat harder than sketching the isometric ellipse. It is narrower and its long diagonal XX does not coincide with HF or lie on the long diagonal BD of the rhomboid, but is midway between these two and is not normally plotted. Similarly, the short diagonal YY is at right angles to YY. Once this is realized, drawing the curve becomes much easier. A large oblique circle requires eight points to draw it smoothly. Four points are obtained by drawing the side dividers EG and HF and then the long and short diagonals of the rhomboid, BD and AC, to intersect at O. The next four points are found by dividing HO and FO in the ratio of 2:5 as shown. Through these points, draw lines parallel to AD and BC to intersect the long and short diagonals to give four more points. Remember the secret of sketching this ellipse is to visualize the positions of XX and YY about which the ellipse is symmetrical.

Of course many sketchers avoid views which entail having circular or cylindrical detail on the oblique faces, preferring to orientate the drawing so that this

type of detail is on the front face where it is circular. Sometimes, however, this cannot be avoided, when circular or cylindrical detail is found on both the front and side faces as with the exercise on page 30.

Corners and rounded ends are drawn using two and five points, respectively, and the appropriate construction rhomboid as shown in Fig. 2(b).

Construction lines used in sketching should be lightly drawn and thus easily removed with a sharp edged rubber. Lining in should be a slow and deliberate process with the sketch pad being turned frequently to follow the line or curve required in the most comfortable manner.

Making best use of the book

This book has been designed to serve a two-fold purpose:

1. It provides a complete course in sketching orthogonal and pictorial views.
2. It tests and improves your ability to interpret drawings by converting from orthogonal to pictorial views and vice versa. This is especially important if you have not been introduced to these topics during your secondary school studies.

Answers are supplied for all the exercises in the book. The exercises are set on one page and answered on the next page (or the previous page where appropriate). You should attempt the exercises before turning the page to check the answers. At the back of the book are several pages with grids only. They may be photocopied so that you can attempt exercises of your own or your instructor's choice.

Complete all the exercises in this course and you should have achieved a reasonable level of knowledge in drawing interpretation as well as a satisfactory level of sketching skills. Good sketching, and rest assured that your level of competence will be commensurate with the effort you put into the exercises.

Note: Paper size in the illustrations has been reduced to slightly smaller than true size. You should use the scales as indicated.

FIGURE 2

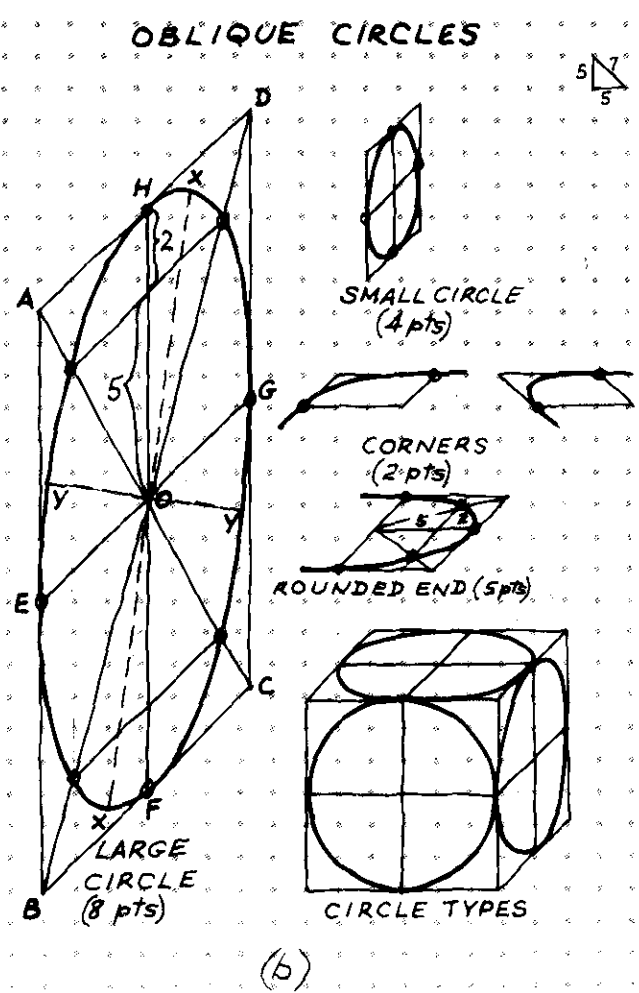
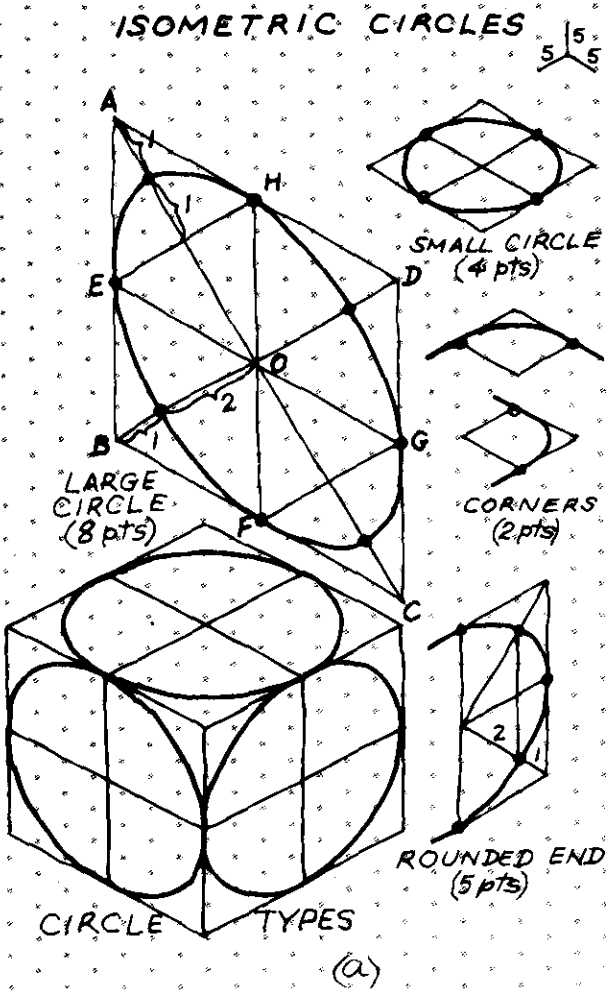

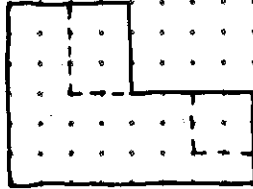
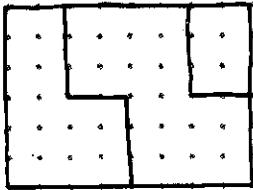

DRAW RS VIEW

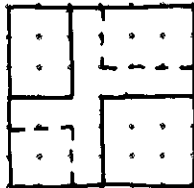
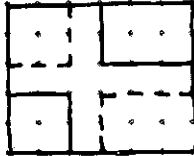

DRAW LS VIEW

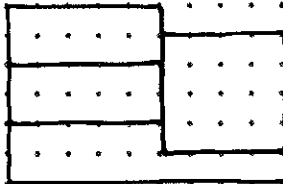
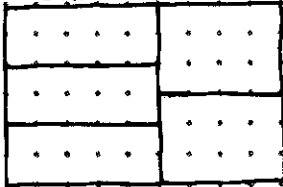

DRAW RS VIEW

DRAW ISOMETRIC VIEW

DRAW ISOMETRIC VIEW

DRAW ISOMETRIC VIEW

DRAW TOP VIEW

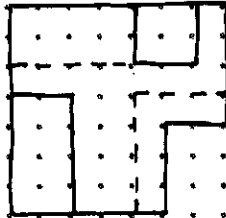
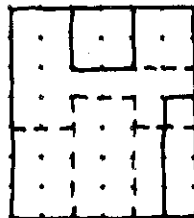

DRAW ISOMETRIC VIEW

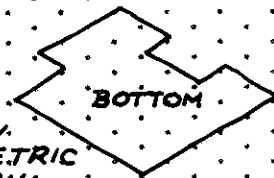

THIRD ANGLE PROJECTION



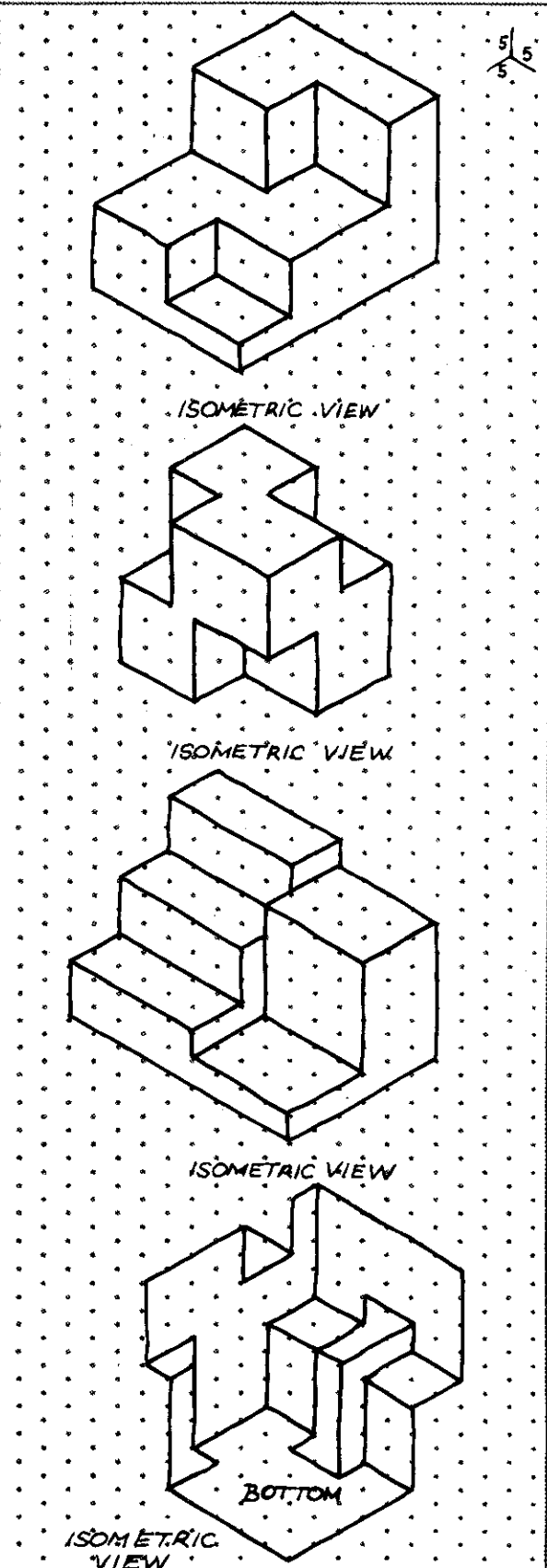
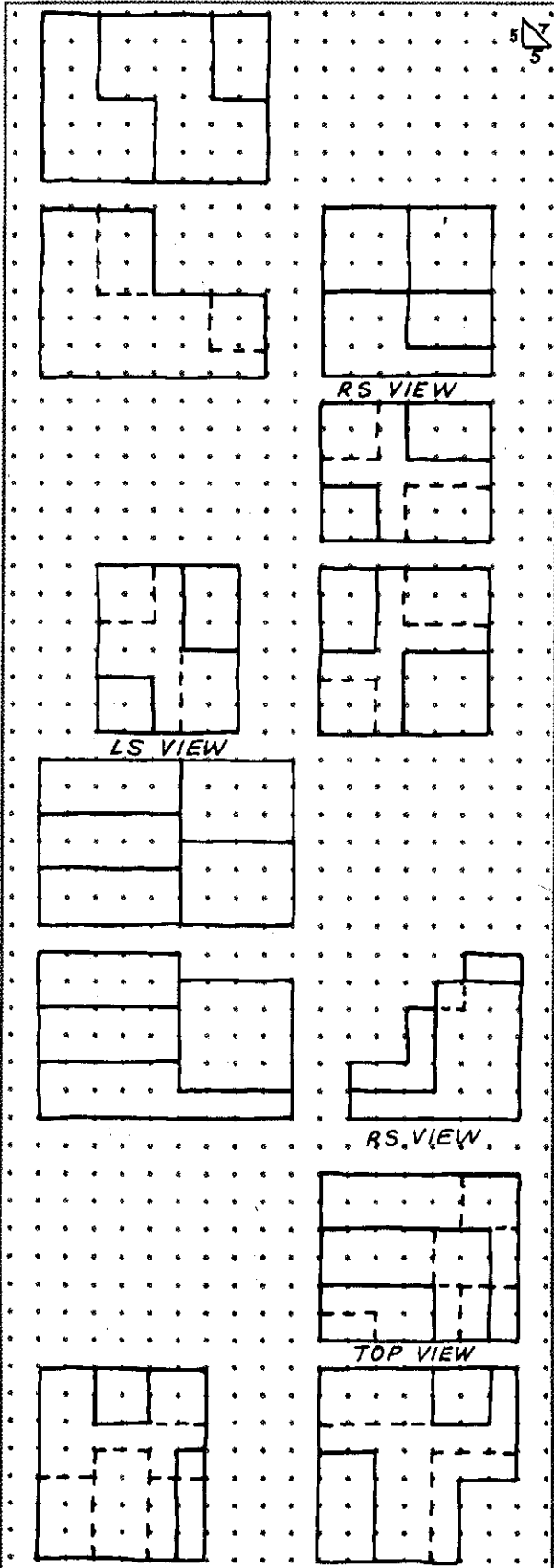

THIRD ANGLE PROJECTION

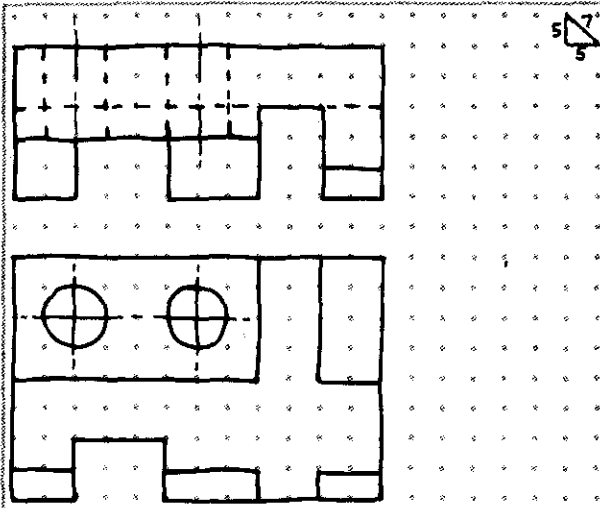

DRAW R/S VIEW

DRAW TOP VIEW

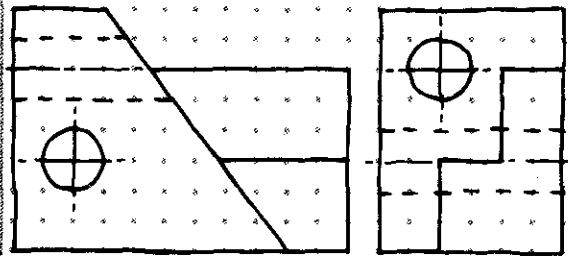

DRAW ISOMETRIC VIEW

DRAW ISOMETRIC VIEW

DRAW TOP VIEW

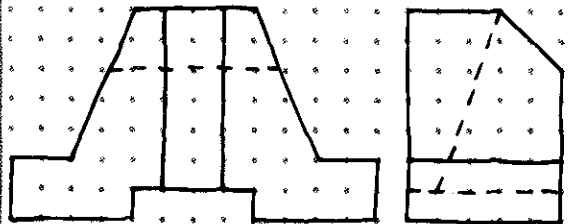

DRAW ISOMETRIC VIEW

THIRD ANGLE PROJECTION

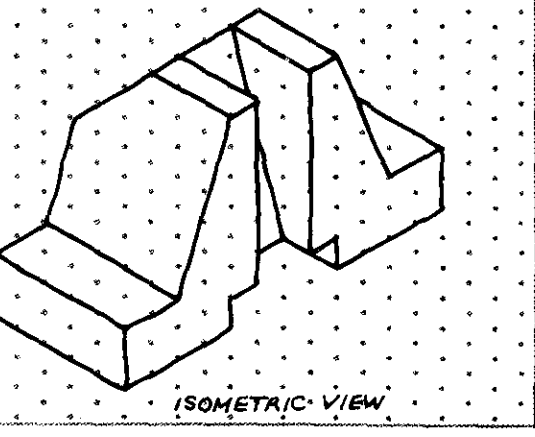
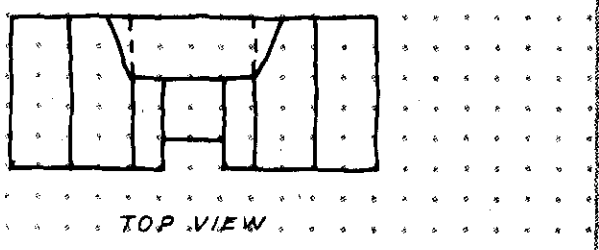
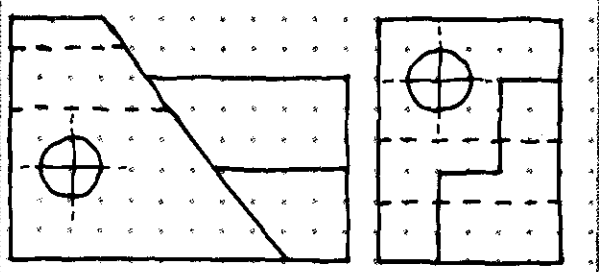
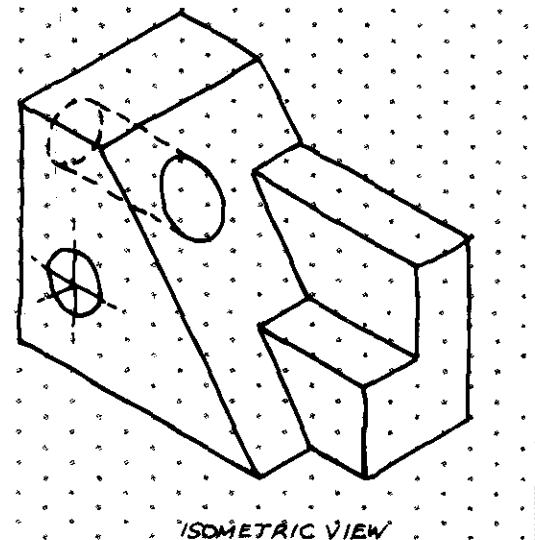
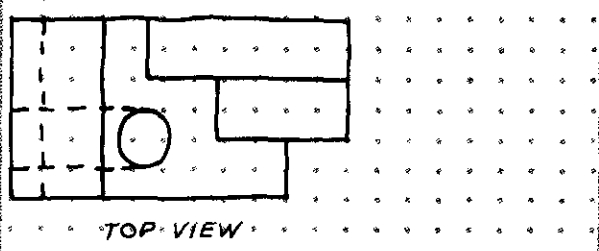
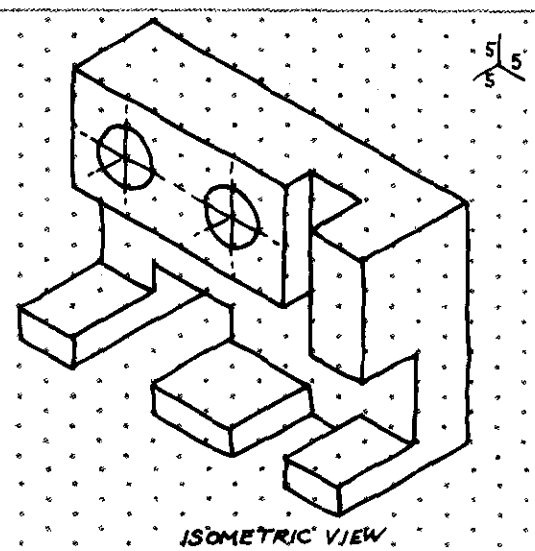
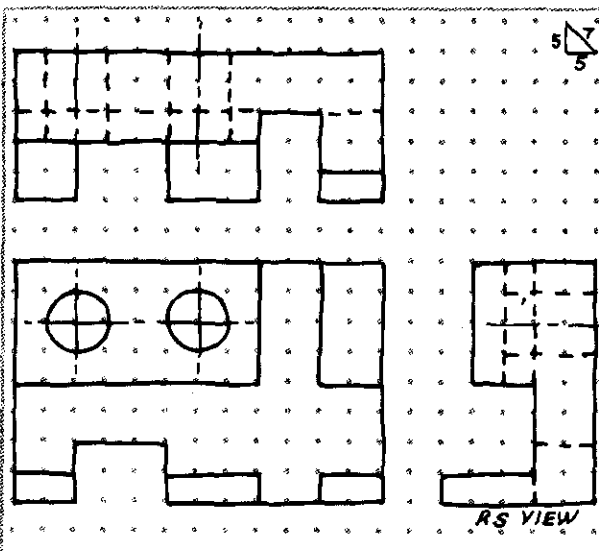

THIRD ANGLE PROJECTION



DRAW TOP VIEW

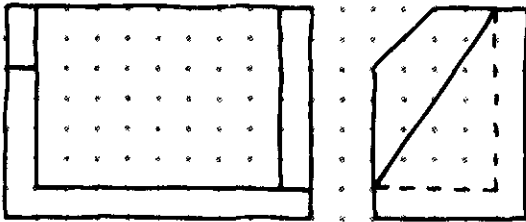

DRAW ISOMETRIC VIEW

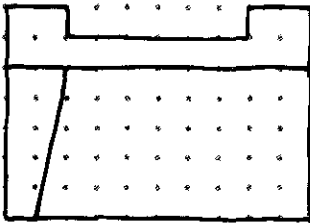

DRAW ISOMETRIC VIEW

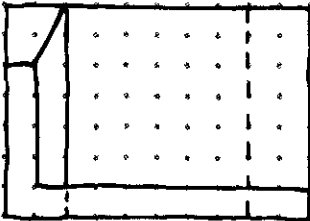

DRAW RS VIEW

DRAW TOP VIEW

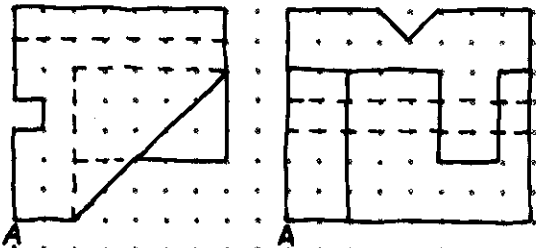

THIRD-ANGLE PROJECTION

COMPLETE ISOMETRIC VIEW



DRAW TOP VIEW

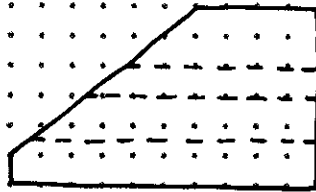
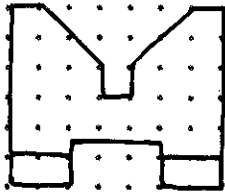

DRAW ISOMETRIC VIEW

DRAW TOP VIEW

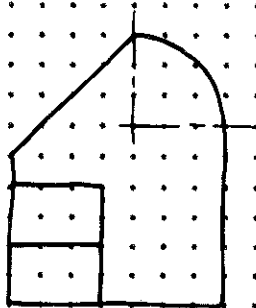
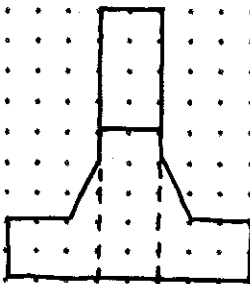

DRAW ISOMETRIC VIEW

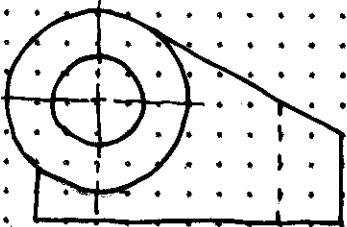
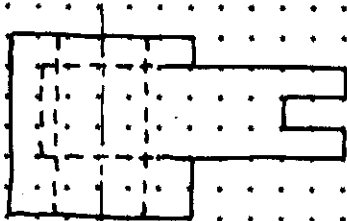

DRAW RS VIEW

DRAW ISOMETRIC VIEW

THIRD ANGLE PROJECTION



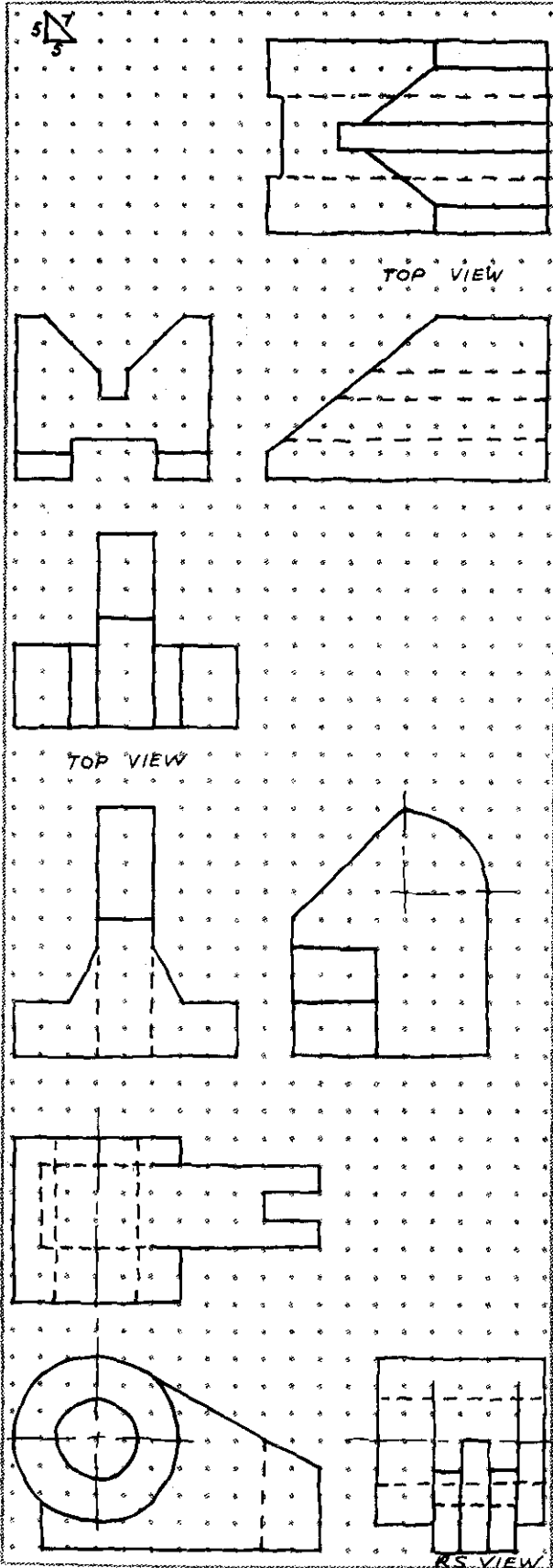

THIRD ANGLE PROJECTION

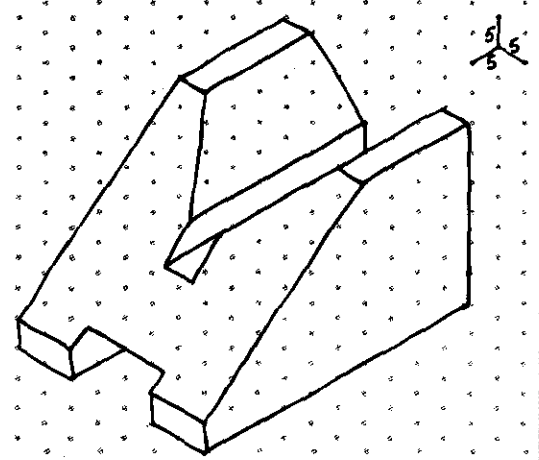

ISOMETRIC VIEW

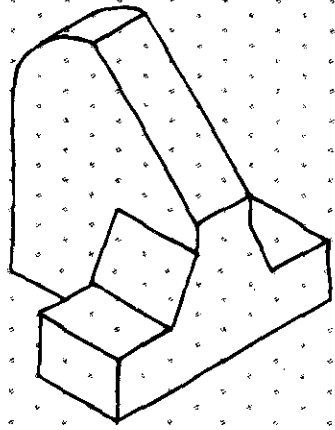

ISOMETRIC VIEW

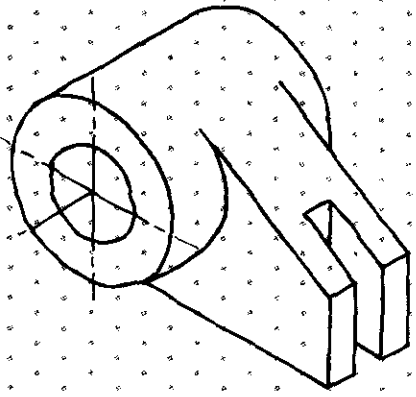

ISOMETRIC VIEW



COMPLETE TOP VIEW

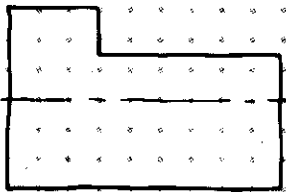

COMPLETE FRONT VIEW

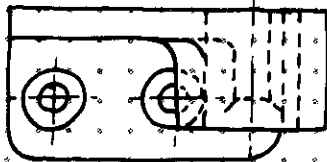

DRAW L.S. VIEW

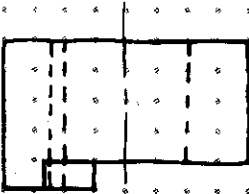

DRAW R.S. VIEW

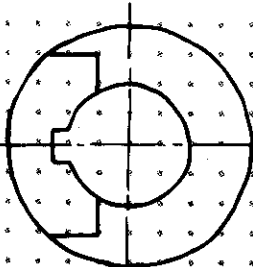

THIRD ANGLE PROJECTION



DRAW ISOMETRIC VIEW

DRAW ISOMETRIC VIEW

DRAW ISOMETRIC VIEW

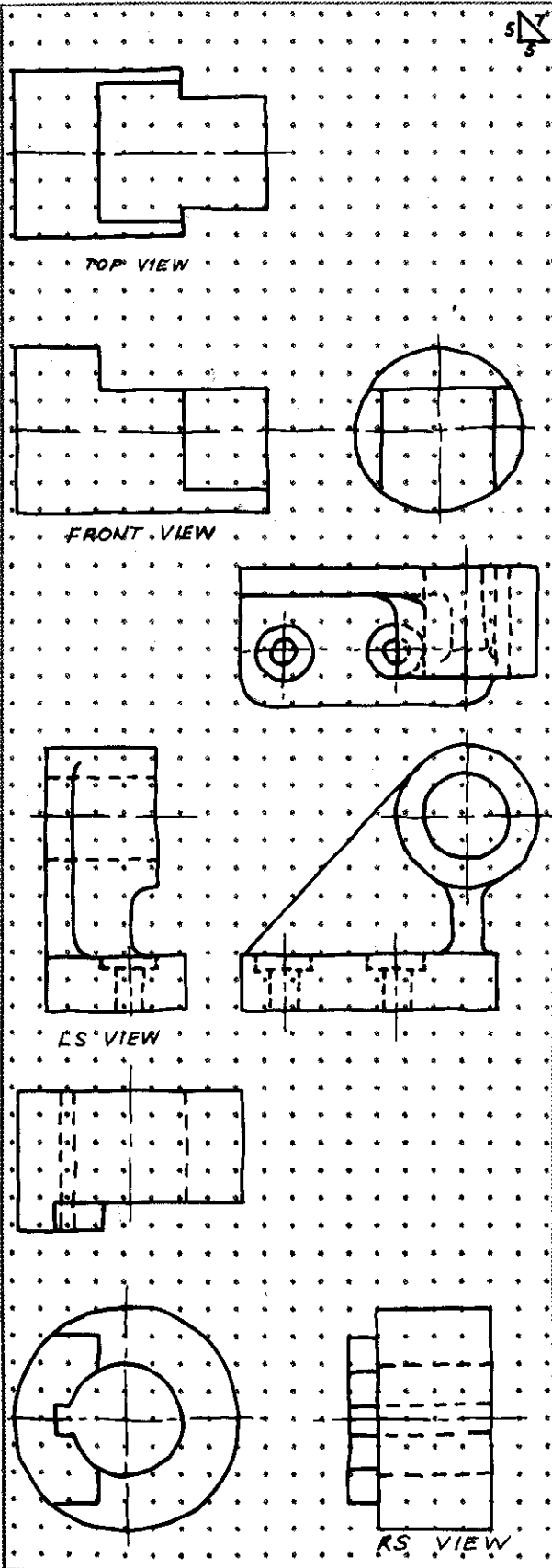

THIRD ANGLE PROJECTION

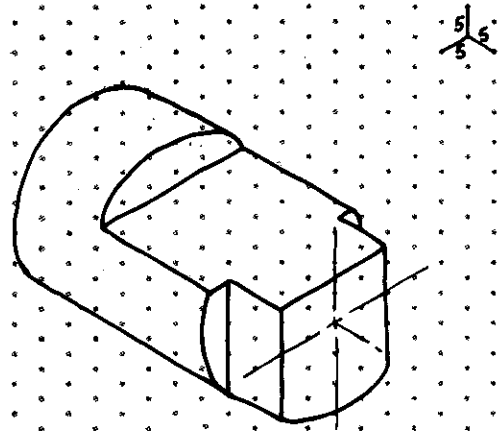

ISOMETRIC VIEW.

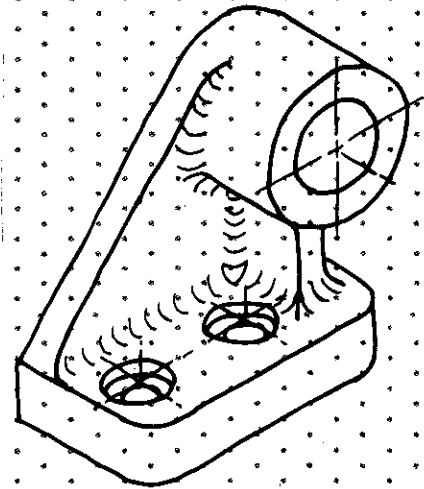

ISOMETRIC VIEW

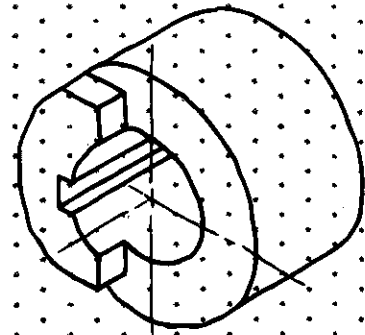

ISOMETRIC VIEW.



DRAW TOP VIEW

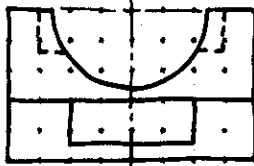
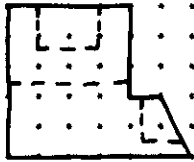

DRAW ISOMETRIC VIEW

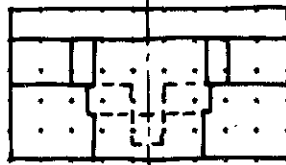

DRAW LS VIEW

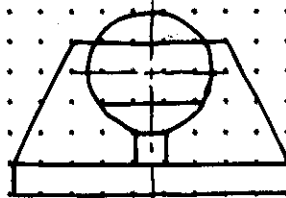

DRAW ISOMETRIC VIEW

DRAW TOP VIEW

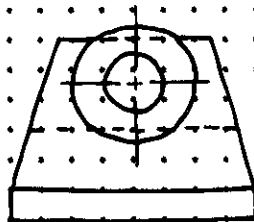
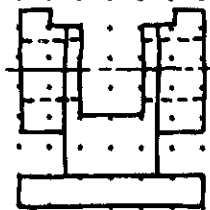

DRAW ISOMETRIC VIEW

THIRD ANGLE PROJECTION

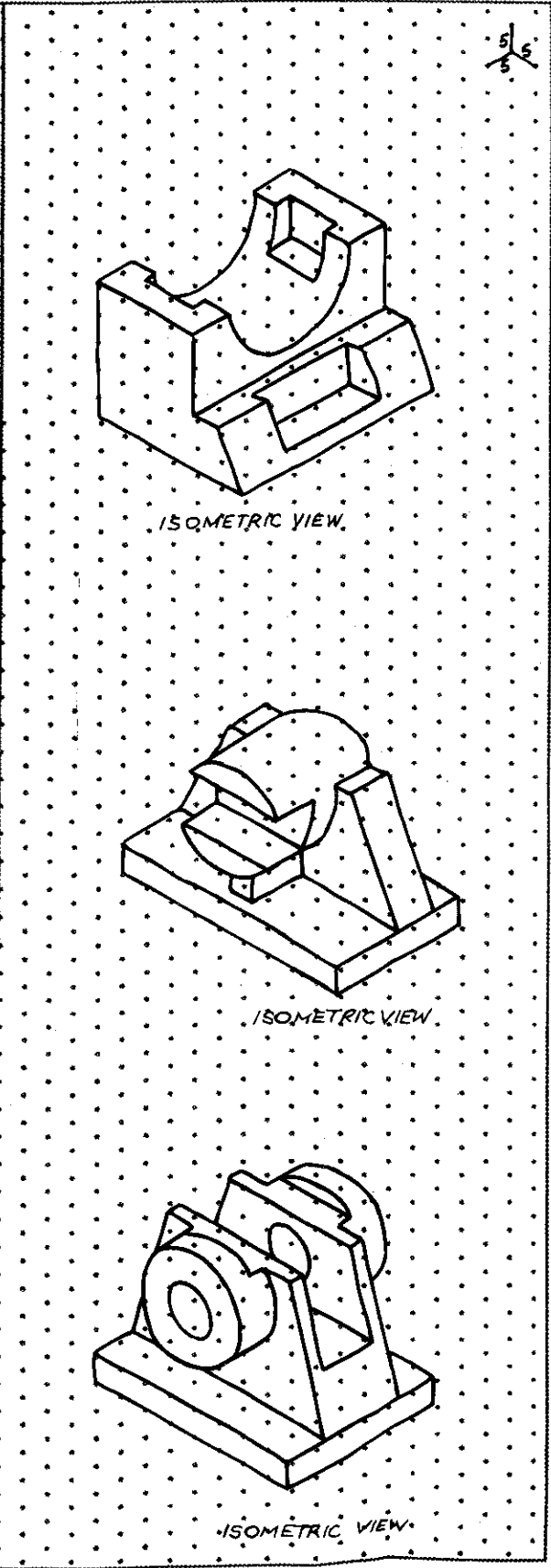
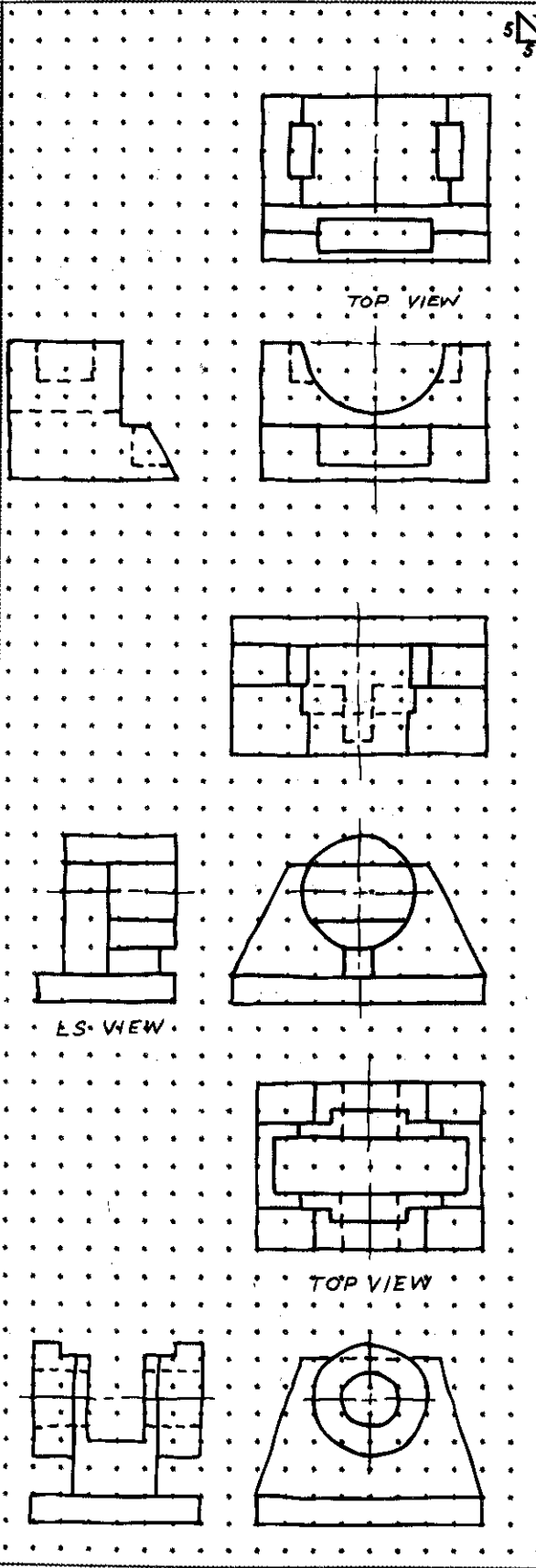



DRAW TV

DRAW FV

DRAW RSV

DRAW TV

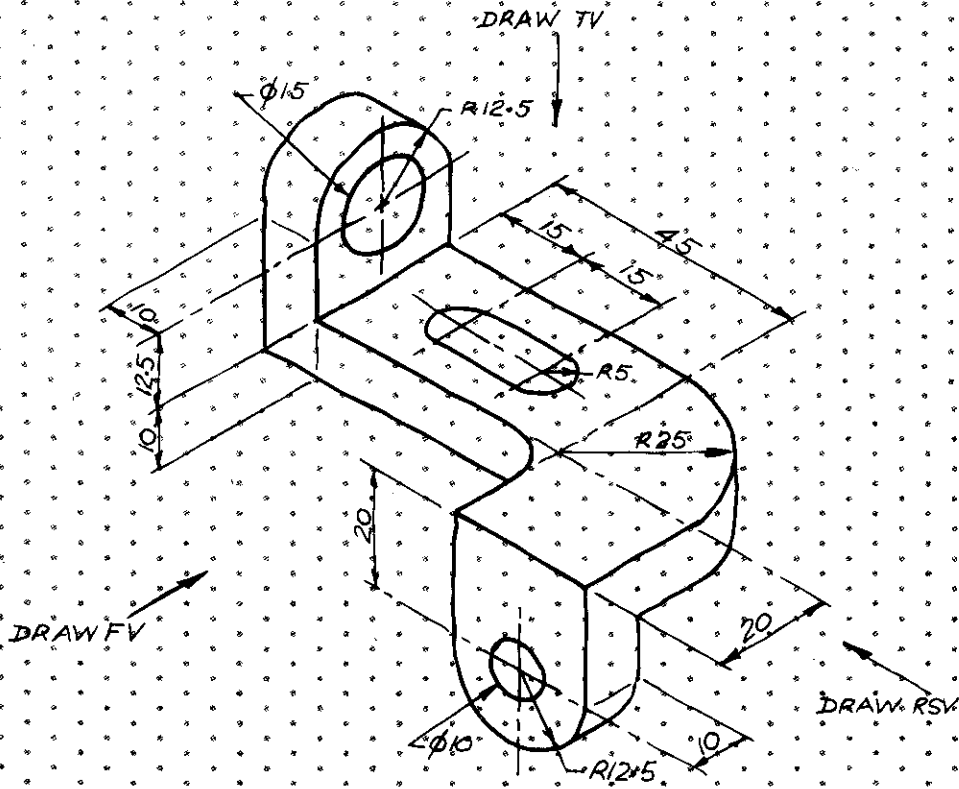

THIRD ANGLE PROJECTION

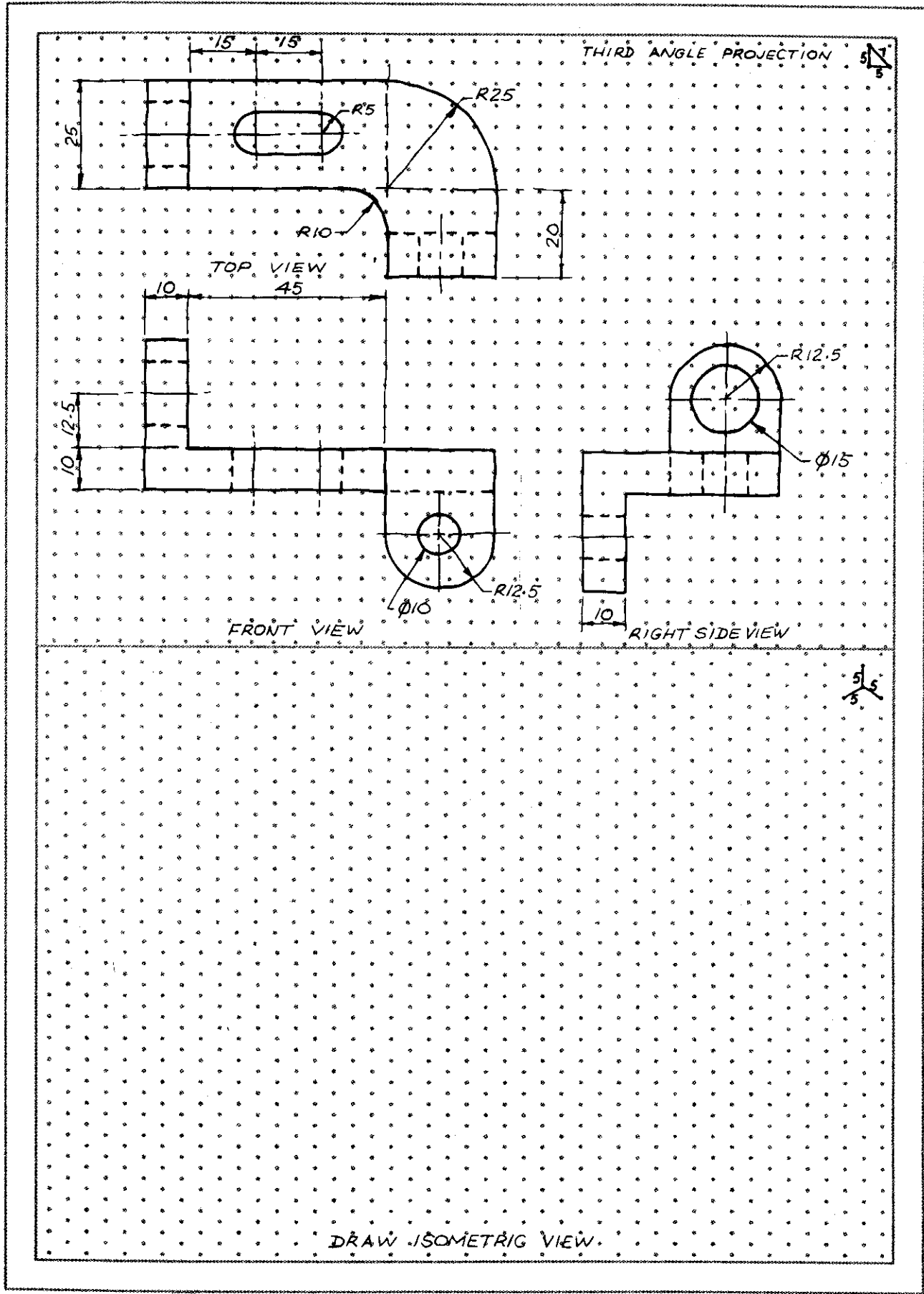

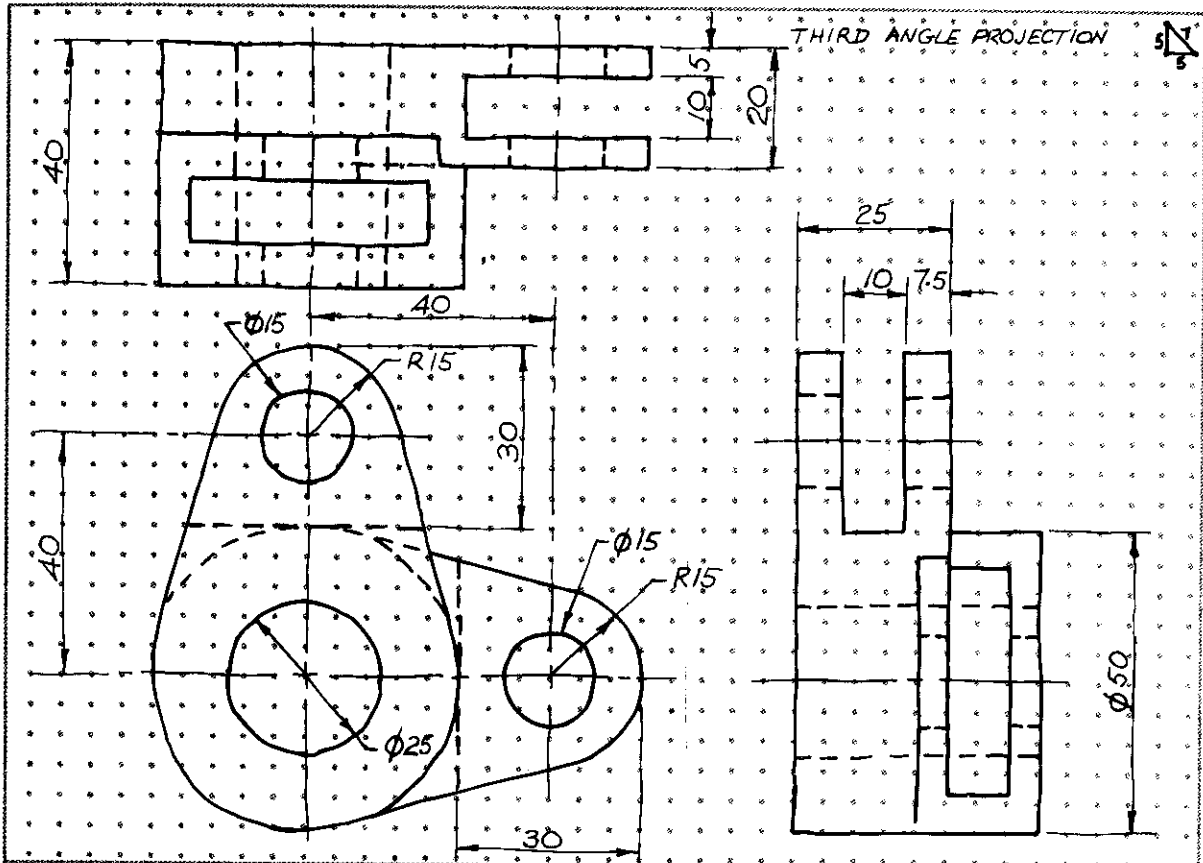

DRAW ISOMETRIC VIEW

DRAW TOP VIEW

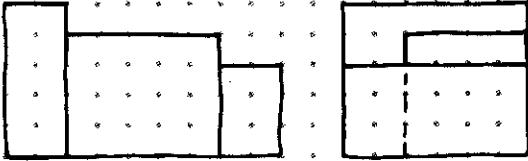

DRAW OBLIQUE VIEW

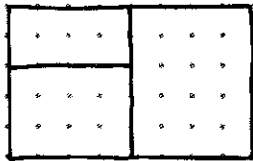
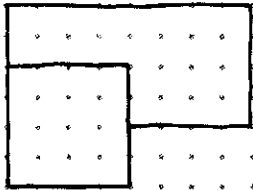

DRAW RS VIEW

DRAW OBLIQUE VIEW

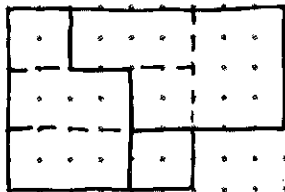

DRAW LS VIEW

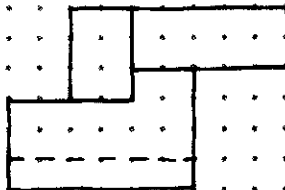

DRAW OBLIQUE VIEW

THIRD ANGLE PROJECTION

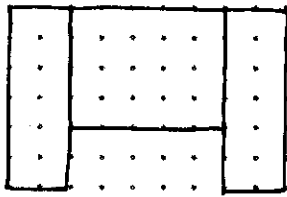

TOP VIEW

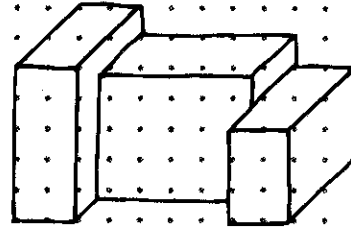
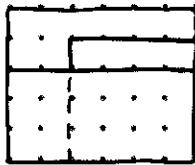
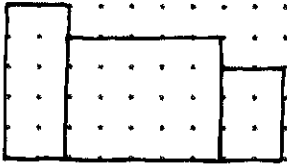

OBLIQUE VIEW

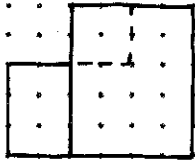
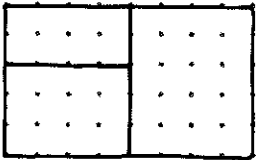
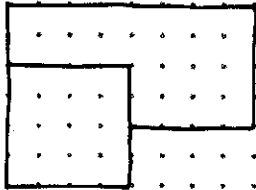

RS. VIEW

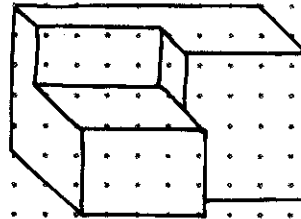

OBLIQUE VIEW

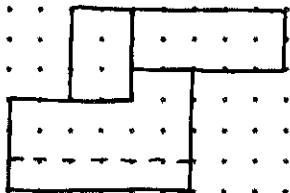
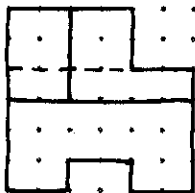
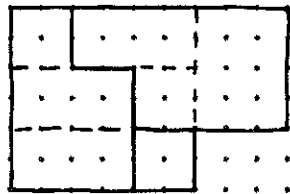

LS VIEW

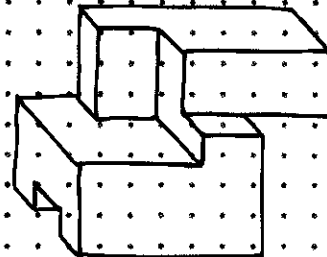

OBLIQUE VIEW

THIRD ANGLE PROJECTION

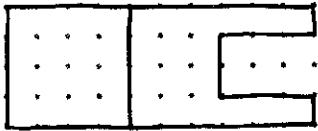

DRAW RS VIEW

DRAW OBLIQUE VIEW

DRAW TOP VIEW

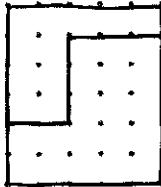

DRAW OBLIQUE VIEW

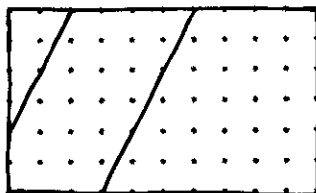
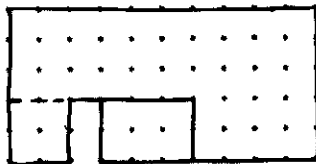

DRAW LS VIEW

DRAW OBLIQUE VIEW

THIRD ANGLE PROJECTION

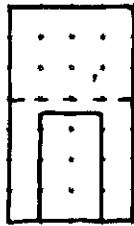
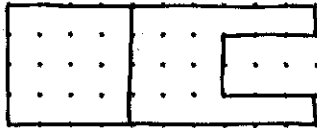

RS VIEW

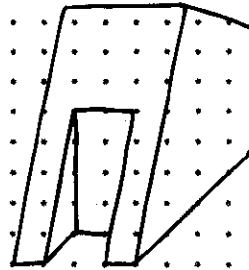

OBLIQUE VIEW

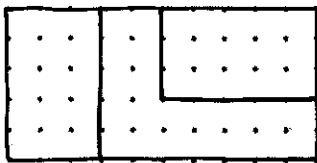

TOP VIEW

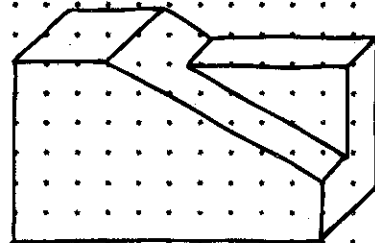

OBLIQUE VIEW

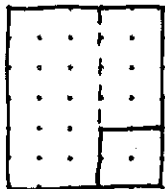
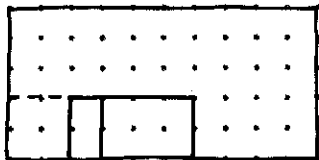
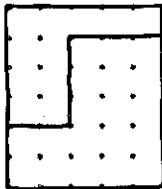
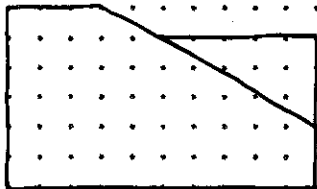

LS VIEW

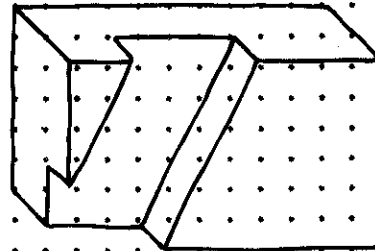
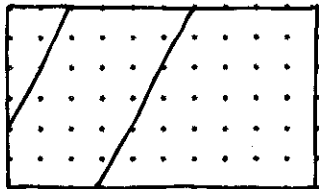

OBLIQUE VIEW

THIRD ANGLE PROJECTION

DRAW TOP VIEW

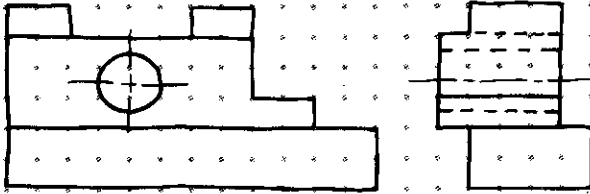

DRAW OBLIQUE VIEW

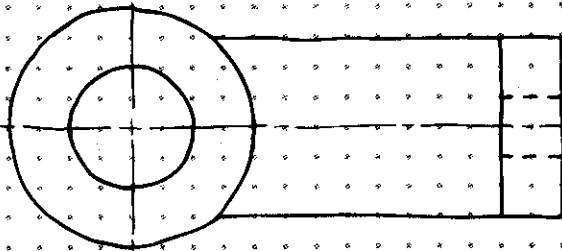
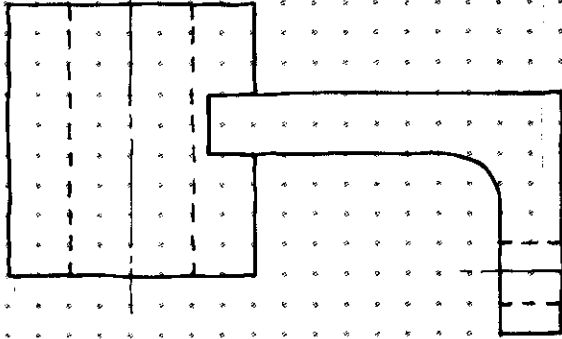

DRAW RS VIEW

DRAW OBLIQUE VIEW

THIRD ANGLE PROJECTION

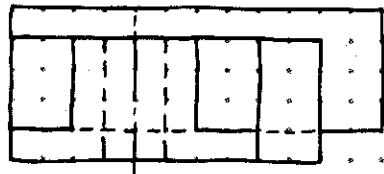

TOP VIEW

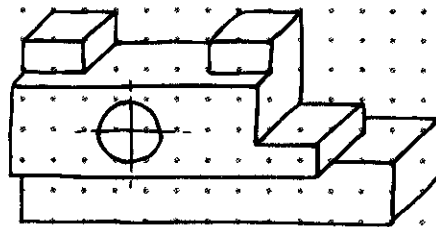

OBLIQUE VIEW

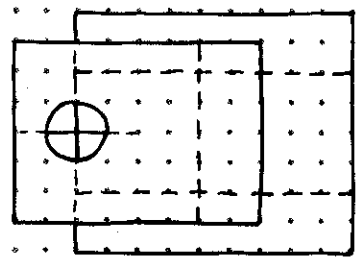
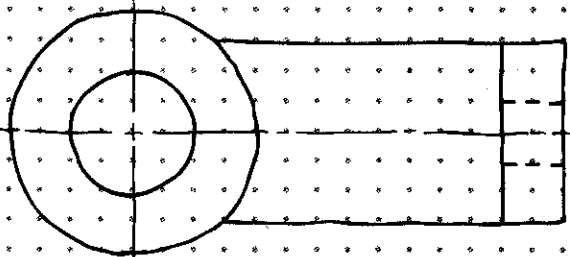
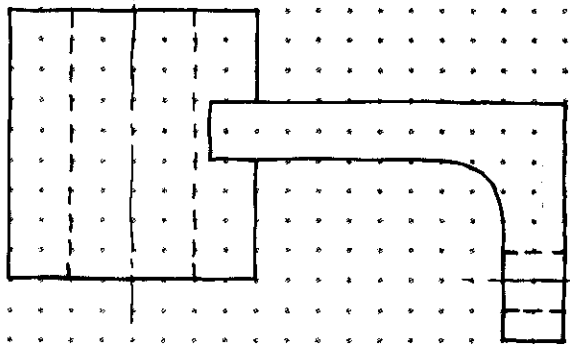
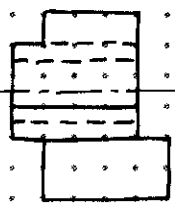
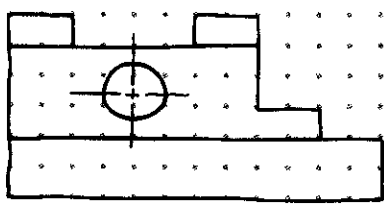

RS VIEW

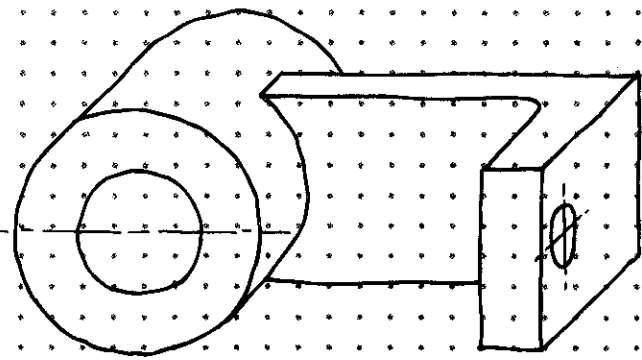

OBLIQUE VIEW

THIRD ANGLE PROJECTION



DRAW TOP VIEW

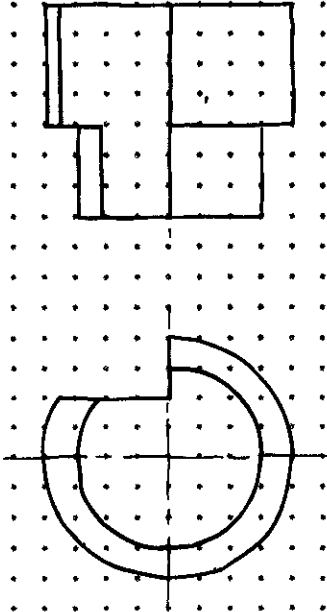

DRAW OBLIQUE VIEW

DRAW SECTION A-A

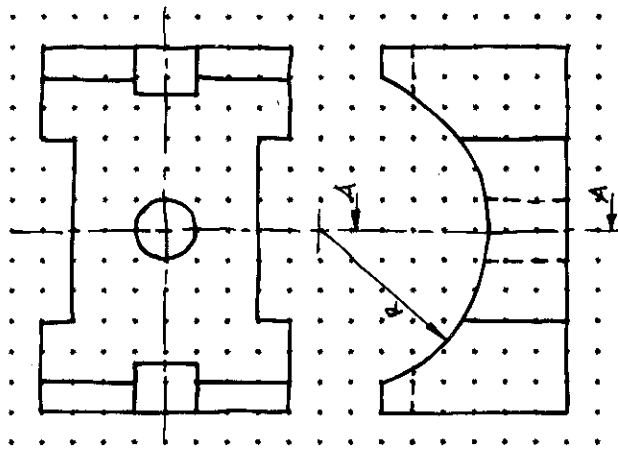

DRAW OBLIQUE VIEW

THIRD ANGLE PROJECTION

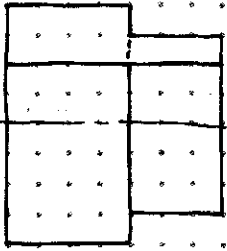

TOP VIEW

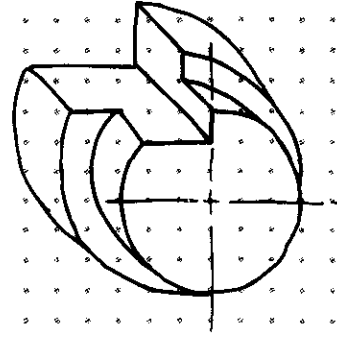
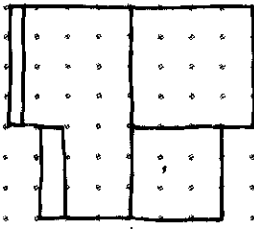
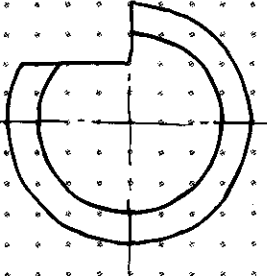

OBLIQUE VIEW

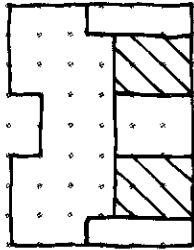
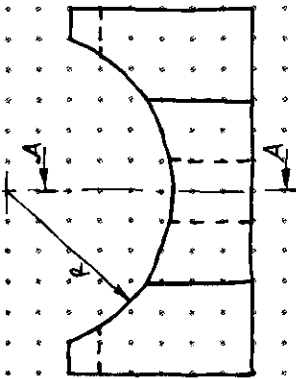
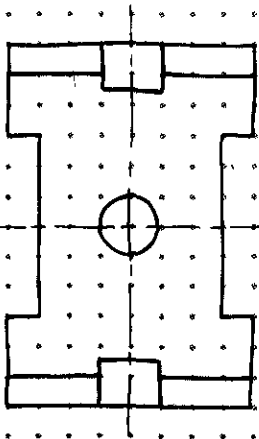

SECTION A-A

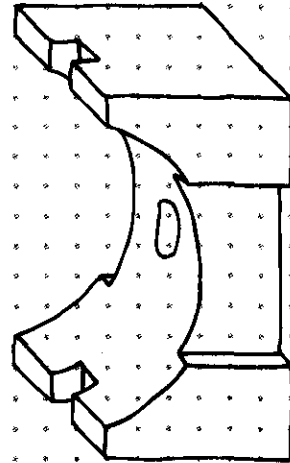

OBLIQUE VIEW

THIRD ANGLE PROJECTION

DRAW TOP VIEW

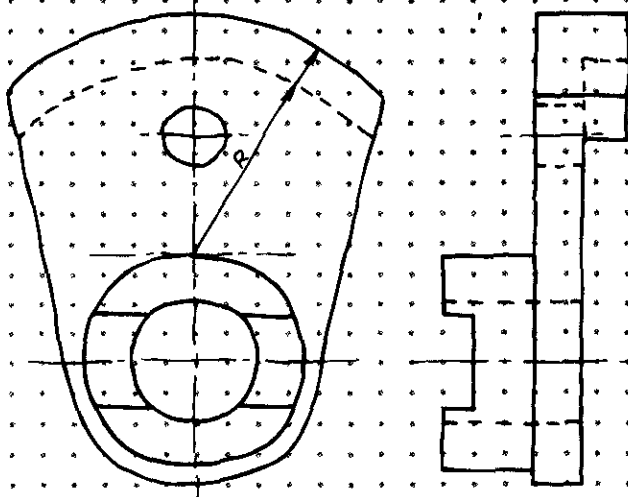

DRAW OBLIQUE VIEW

DRAW TOP VIEW

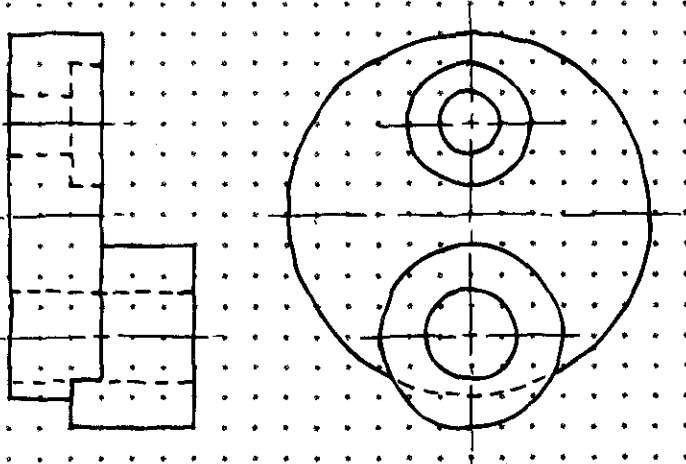

DRAW OBLIQUE VIEW

THIRD ANGLE PROJECTION

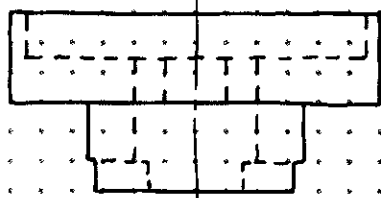

TOP VIEW

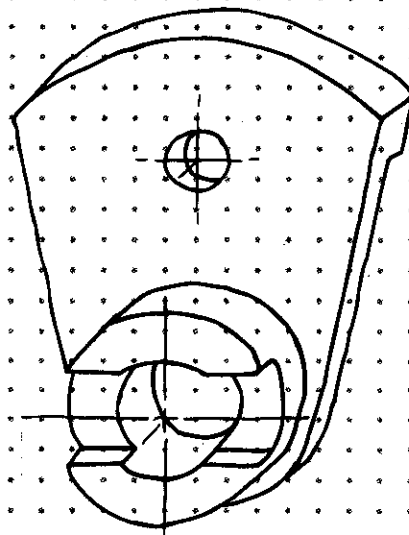
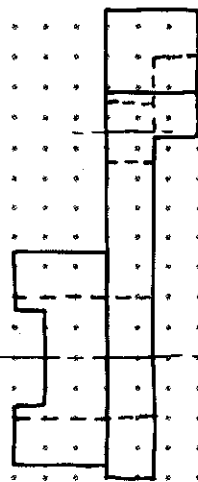
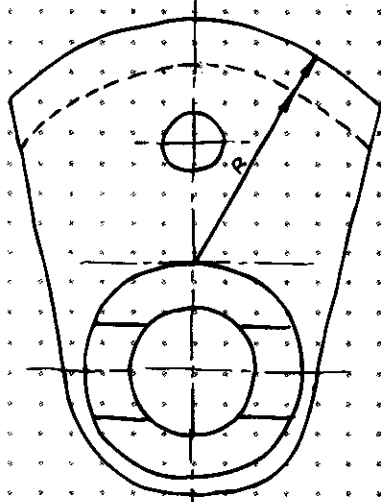

OBLIQUE VIEW

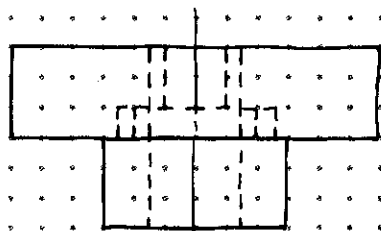

TOP VIEW

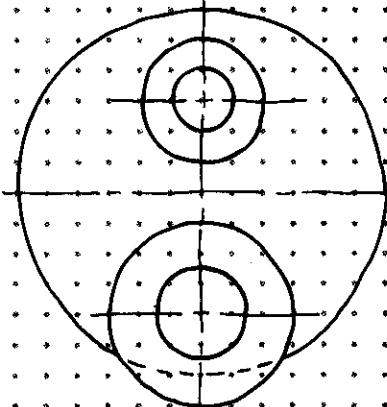

OBLIQUE VIEW

THIRD ANGLE PROJECTION

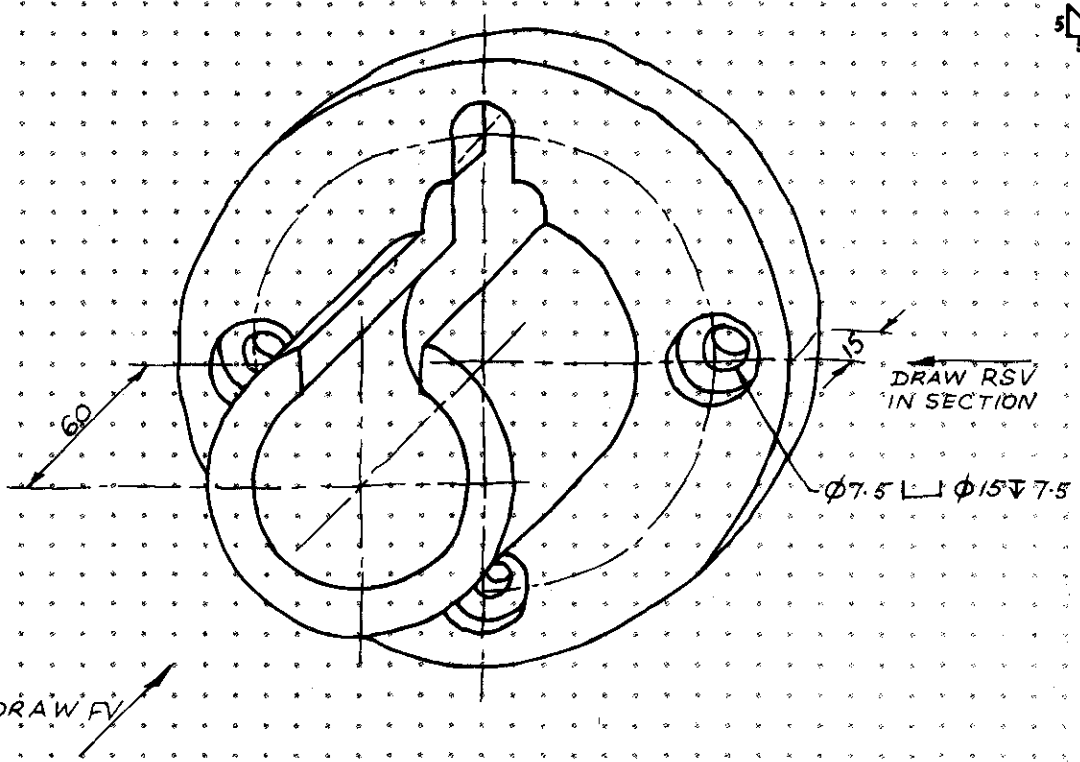

DIMENSION VIEWS

THIRD ANGLE PROJECTION

DRAW OBLIQUE VIEW

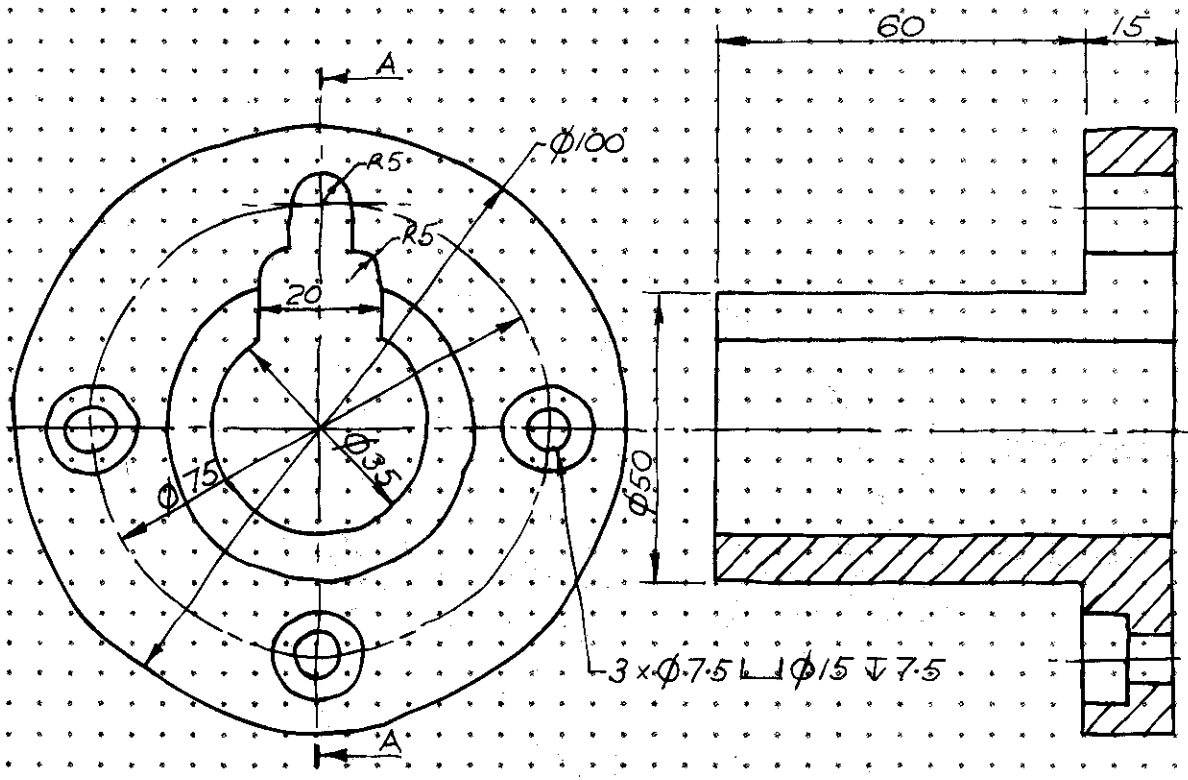

FRONT VIEW

SECTION AA

THIRD ANGLE PROJECTION



DIMENSION VIEWS

DRAW TOP VIEW

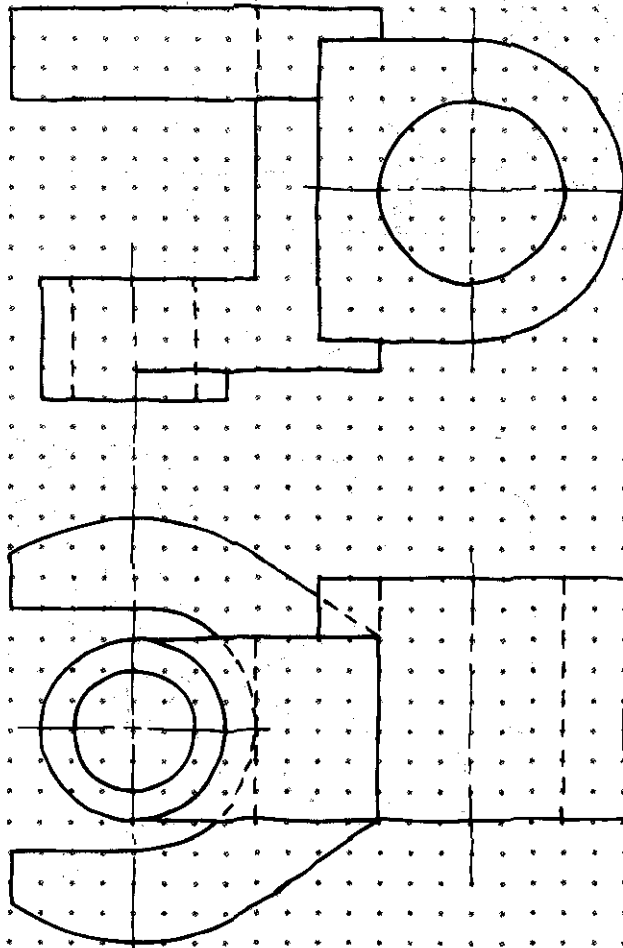

DRAW OBLIQUE VIEW

THIRD ANGLE PROJECTION

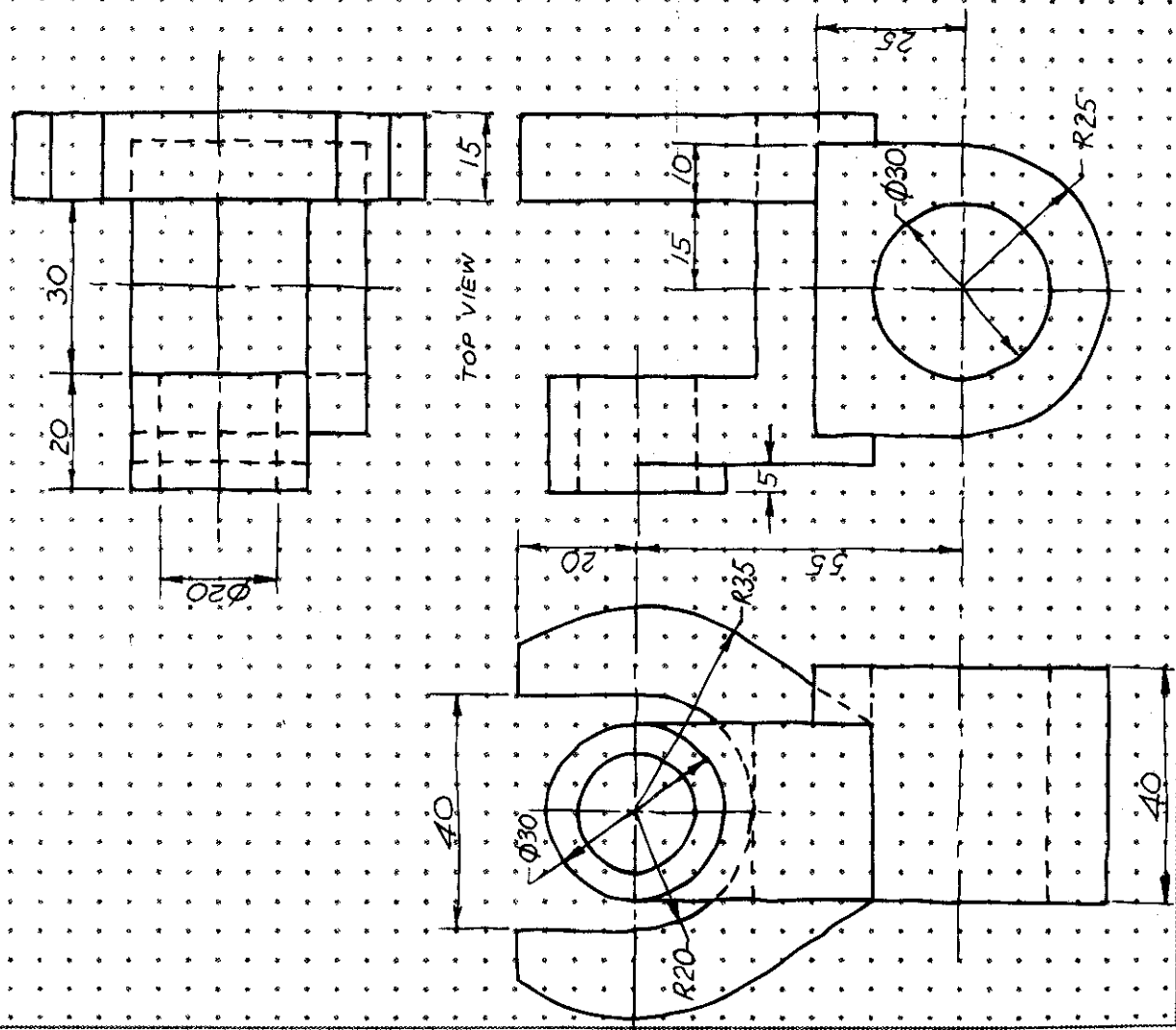

OBLIQUE VIEW

THIRD ANGLE PROJECTION

