

Designing Geodatabases

Case Studies in GIS Data Modeling

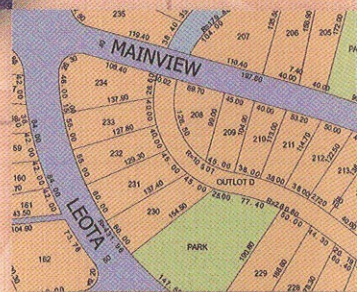
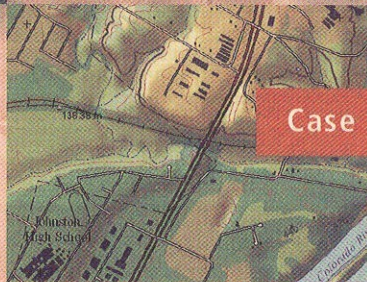

David Arctur • Michael Zeiler

preface ix

how to use this book xii

companion web site for ArcGIS data models xiv

chapter 1

geodatabase design 2

Spatial data modeling is an extension to conventional methodologies for conceptual, logical, and physical data modeling within a relational or object-oriented database. This chapter presents steps to design, a guide for reading data model illustrations, and recurring patterns used in geodatabase design.

chapter 2

streams and river networks 36

Surface water flow is a fundamental part of many maps. It is also the subject of intense examination and research to understand and anticipate the effects of irrigation, storms, and flooding. This chapter summarizes the key points of Arc Hydro, a mature data model for hydrographic and hydrologic modeling applications.

chapter 3

census units and boundaries 86

Census data comprises two main types of information: location and demographics. This data model focuses on the spatial hierarchy of physical features, census blocks, block groups, tracts, and higher-level administrative units. With these concepts, the rich demographic data can be easily joined to the spatial features for further analysis.

chapter 4

addresses and locations 126

Streets can have multiple names and address ranges; buildings, parcels, and points of interest can have multiple addresses and subaddresses; and addresses can have many different styles and be used by multiple features. This case study from Calgary, Canada, shows how to support such complex relationships in a straightforward way.

contents

chapter 5

parcels and the cadastre

166

Based on a case study from Oakland County, Michigan, this data model shows how to integrate survey control with the parcel framework and provides a decision tree for choosing parts of the model to use. It presents alternative ways of modeling parcels and ownership and discusses history tracking and cartography.

chapter 6

surveying federal lands

220

This data model is based on the U.S. BLM National Integrated Land System, used for managing case records pertaining to transfers and subdivisions of public lands. The chapter describes the work flow and key modules of NILS: survey management, measurement management, legal description fabric, and parcel management.

chapter 7

using raster data

280

Raster imagery is used in several distinct ways: as scanned maps, as grids of measurement data, as aerial and satellite orthophotos, and as time series of any of these rasters. This chapter provides guidelines for the best ways of managing raster data in a geodatabase using raster datasets, raster catalogs, and mosaics.

chapter 8

cartography and the base map

306

This case study examines two distinct issues: demonstrating the development of a topographic base map based on a case study from the Texas Natural Resources Information System, and extending a GIS to support cartographic quality output, using the topographic base map for illustration.

chapter 9

building geodatabases

374

As you design your data model, you will use ArcGIS tools and techniques to build the geodatabase. This chapter presents six steps for implementing your design.